



Kimber Road, SW18 | £1,500 Per Month



**TUCKERMAN**  
E S T A T E   A G E N T S  
PROPERTY PROFESSIONALS



# Coleman Court, Kimber Road, London

Open House - Wednesday 9th October @ 6pm. Please enquire to confirm attendance.

This charming apartment offers a cozy retreat with its 1 reception room, 1 bedroom, and 1 bathroom, perfect for those seeking a comfortable living space in the bustling city.

Built in 1950, this apartment exudes character and history, making it a unique find in the London property market. The bedroom comes with an en-suite bathroom, providing convenience and privacy for the residents.

Situated in a secure building, Coleman Court offers peace of mind for those looking for a safe and welcoming environment. The well-kept communal gardens add a touch of greenery to the urban setting, creating a tranquil oasis for residents to enjoy.

With a total of 385 sq ft of living space, this apartment is ideal for individuals or couples looking to experience city living at its finest. Don't miss out on the opportunity to make Coleman Court your new home in London!

## DESCRIPTION

This delightful property boasts a cosy reception room, perfect for relaxing after a long day. With one spacious bedroom, this apartment is ideal for individuals or couples looking for a comfortable living space.

The apartment features a modern kitchen with integrated appliances, a bright and roomy reception room and a spacious double bedroom with en-suite bathroom, providing convenience and privacy. The property also offers access to communal gardens, where you can enjoy the outdoors without leaving the comfort of your home.

Built in 1950, this apartment exudes character and charm, offering a unique living experience. The double bedroom provides ample space for rest and relaxation, while the proximity to King George's Park allows for leisurely strolls in a picturesque setting.

Conveniently located opposite King George's Park, this apartment offers a tranquil escape from the hustle and bustle of city life. With excellent transport links from Southfields Station or Earlsfield, commuting to work or exploring the city is a breeze.

Don't miss this opportunity to make this lovely apartment your new home. Book a viewing today and experience the comfort and convenience this property has to offer.

## COUNCIL TAX

Band B - £710.99 for 2023/24









# Coleman Court, Kimber Road,

Let

Per Month: £1,500 Per Month

Furnishing: Unfurnished

Available From: 24th September 2024

Local Authority: London Borough of  
Wandsworth

Council Tax Band: B

Approximate Gross Internal Area:  
385.00 sq ft

Energy Efficiency Rating

	Current	Potential
<div> <div>Very energy efficient - lower running costs</div> <div> <div>(92 plus) A</div> <div>(81-91) B</div> <div>(69-80) C</div> <div>(55-68) D</div> <div>(39-54) E</div> <div>(21-38) F</div> <div>(1-20) G</div> <div>Not energy efficient - higher running costs</div> </div> </div>	<div>70</div>	<div>75</div>

England & Wales

EU Directive

2002/91/EC

# Coleman Court, Kimber Road SW18

Gross internal area (approx.)  
35 Sq m (377 Sq ft)  
For identification only, Not to Scale

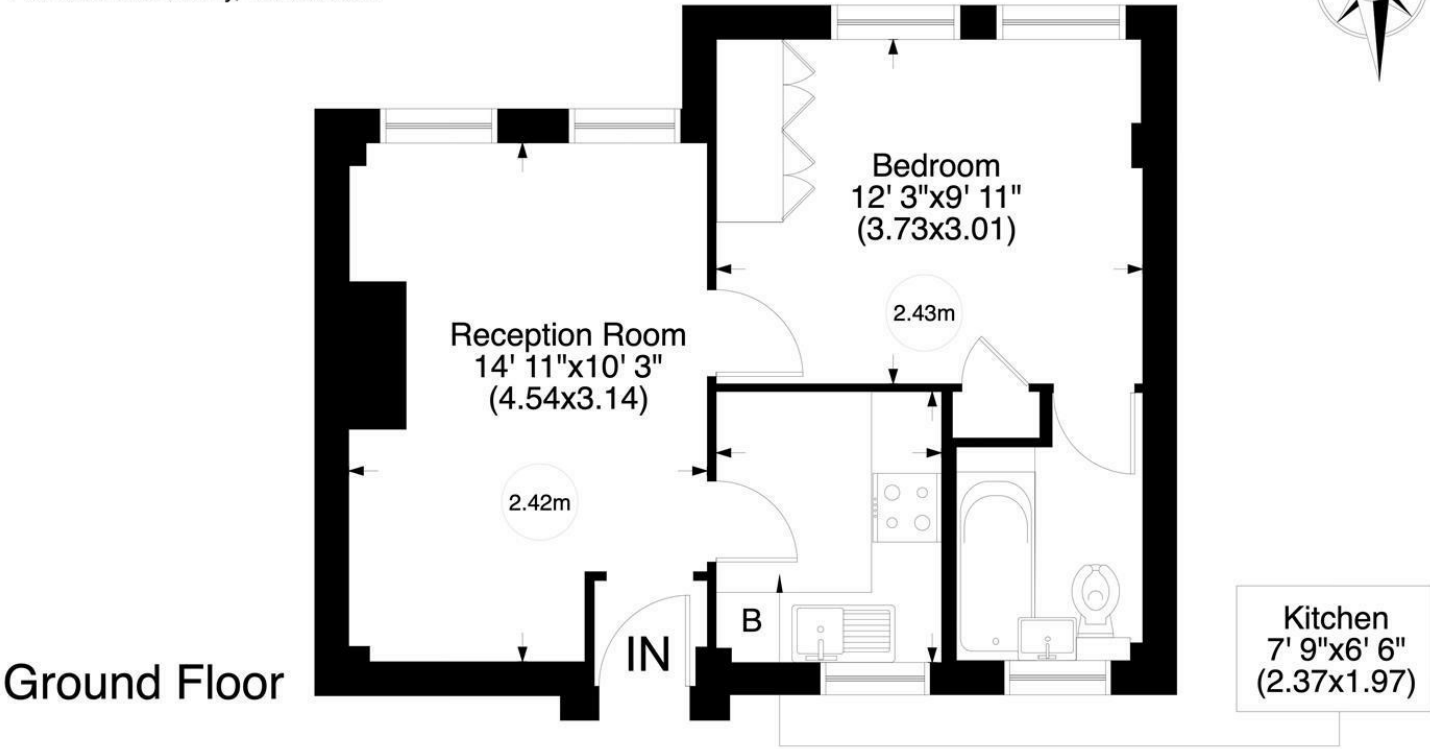

www.WilliamSalisbury.Photography

Not to Scale, for guidance only and must not be relied upon as a statement to fact. All measurements areas are approximate only (and have been prepared in accordance with the current edition of the RICS Code of Measuring Practice).

020 7222 5510

info@tuckermanresidential.co.uk  
52 Moreton Street, London, SW1V 2PB  
www.tuckermanresidential.co.uk

Agents Note: Whilst every care has been taken to prepare these sales particulars, they are for guidance purposes only. All measurements are approximate are for general guidance purposes only and whilst every care has been taken to ensure their accuracy, they should not be relied upon and potential buyers are advised to recheck the measurements

TUCKERMAN

ESTATE AGENTS

PROPERTY

PROFESSIONALS